

IR LED CAMERA

TEC-C212H

12PCS IR LED CAMERA



- FEATURES -

- 1/3" SONY High-Resolution Super HAD CCD
- 480TV Lines Horizontal Resolution
- 12pcs IR-LED for night vision (Day & Night)
- Visibility Range : 10m
- Board Lens : 2.9mm

Option

- Audio



1/3 SONY DSP
Super HAD CCD



COLOR



DAY & NIGHT



2.9mm
BOARD LENS



12pcs IR LED



DC 12V

- DIMENSION -

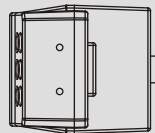
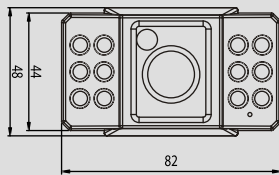
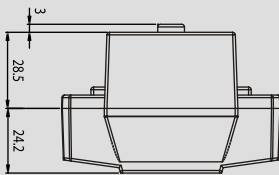

- I-TYPE -



TEC-C212HI

- SPECIFICATION -

TEC-C212H		
Signal Format	NTSC	PAL
Horizontal Resolution	480TV Lines	
Image Sensor	1/3" SONY High-Resolution Super HAD CCD	
Scanning System	525 lines interlaced	625 lines interlaced
Synchronization	Internal	
Video Output	CVBS : 1.0Vp-p/75Ω	
Min. Illumination	Day : 3Lux, Night : 0.00Lux (IR LED On)	
Signal to Noise Ratio	45dB or more (AGC Off)	
Gamma	0.45	
AGC	On	
Input Voltage	DC 12V (±10%)	
Power Consumption	IR LED OFF : Max 2.0W or less IR LED ON : Max 3.2W or less	
Operating Temperature	-10°C to +55°C	
Storage Temperature	-20°C to +70°C	
Operating Humidity	Under 90% Non-condensing	
Storage Humidity	Under 90% Non-condensing	
Lens	Board Lens : 2.9mm	
Dimension	82.0(W) x 48.0(H) x 55.7(D)mm	
Weight	170g (W/O Bracket)	
Option	I-Type, Audio	