

# DOME CAMERA

## TDC-512EM/DV28

680TVL / 3D-DNR / SENS-UP COLOR DOME CAMERA



### - FEATURES -

- 1/3" SONY 960H Ex-view HAD II CCD
- 680TV Lines Horizontal Resolution
- Excellent Low Light Sensitivity of 0.1Lux/F1.2
- Sens-up : x1024 (0.0004Lux/F1.2)
- Day & Night
- Digital WDR : Digital Wide Dynamic Range
- 3D-DNR : 3D-Digital Noise Reduction
- HLC : High Light Compensation
- DIS : Digital Image Stabilizer
- Motion Detection
- Privacy
- x8 Digital Zoom & Digital Pan / Tilt
- Built-in OSD Controller
- DC Varifocal Lens f=2.8~11.0mm
- 3-Axis Gimbal Bracket

Option : RS-485 / Wall Mount Bracket

\* TDC-524EM/DV28 : Dual Voltage (DC 12V / AC 24V)



1/3 SONY 960H EX-VIEW HAD II CCD



DAY & NIGHT



DIGITAL WDR  
DIGITAL WIDE DYNAMIC RANGE



3D DNR  
3D-DIGITAL NOISE REDUCTION



SENS-UP SENS-UP  
x1024 SENS-UP



HLC  
HIGH-LIGHT COMPENSATION



DIS  
DIGITAL IMAGE STABILIZER



FLICKERLESS



2.8-11.0mm VARIOFocal LENS



3-AXIS GIMBAL

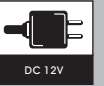

DC 12V

### - DIMENSION -

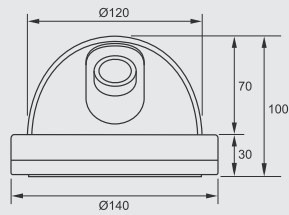
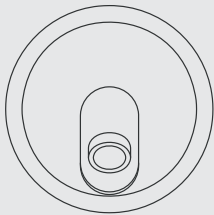

### - 3-AXIS GIMBAL BRACKET -



- Camera Rotation : 360°
- Tilt Rotation : 100°
- Pan Rotation : 270°

### - POWER BOARD (Dual Voltage) -



- Video Loop-Out
- Dual Voltage (DC 12V / AC 24V)
- OSD Controller

### - WALL MOUNT BRACKET -



MBR-120WM

### - SPECIFICATIONS -

TDC-512EM/DV28		
Signal Format	NTSC	PAL
Horizontal Resolution	680TV Lines	
Image Sensor	1/3" SONY 960H Ex-view HAD II CCD	
Effective Pixels	976(H) x 494(V)	976(H) x 582(V)
Scanning System	2:1 Interlace	
Synchronization	Internal	
Scanning Frequency	15.734 KHz(H), 59.94 Hz(V)	15.625 KHz(H), 50.00 Hz(V)
Video Output	CVBS : 1.0Vp-p/75Ω	
Min. Illumination	Color : 0.1Lux/F1.2 (Sens-up : 0.0004Lux/F1.2) BW : 0.01Lux/F1.2 (Sens-up : 0.00004Lux/F1.2)	
Electronic Shutter	1/60 ~ 1/10,000 sec	1/50 ~ 1/10,000 sec
Iris Control	ALC (DC Auto Iris)	
Signal to Noise Ratio	52dB	
Backlight Compensation	OFF / BLC / HLC	
White Balance	ATW1 / ATW2 / AWC / PUSH / MANUAL / INDOOR / OUTDOOR	
Gain Control	OFF ~ 36dB (3dB Unit)	
3D-DNR	OFF / ON	
Day & Night	AUTO / DAY / NIGHT / EXT1 / EXT2	
Sens-up	x1024	
Digital WDR	OFF / LOW / MIDDLE / HIGH	
Digital Image Stabilizer	OFF / ON	
Digital Zoom	OFF / ON (Level 1-8), Digital Pan/Tilt	
Flickerless	OFF / ON	
Motion Detection	48 Area Zone Masking	
Privacy	24 Area	
Rotate / Flip	OFF / H-FLIP / V-FLIP / ROTATE	
Sharpness	Level Adjustable	
Camera ID	OFF / ON (Max.20ea/1Line)	
Communication	RS-485 (PELCO-D/P)	
OSD	Eng, Chi, Jpn, Ita, Deu, Spa, Por, Rus	
Lens	DC Varifocal Lens f=2.8~11.0mm	
Input Voltage	DC 12V (±10%)	
Power Consumption	Max. 1.5W	
Operating Temp/Hum	Temperature : -10°C ~ +50°C / Humidity : Less than 90%	
Dimension	140(Ø) x 100(H)mm	
Weight	Approx. 380g	

In accordance with customers' request and OSD controller's option, the specifications can be fixed or changed without notice.