

TEC-C212QLS

580TVL / SENS-UP / 12 IR LED CAMERA



- FEATURES -

- 1/3" SONY High-Resolution Super HAD II CCD
- 580TV Lines Horizontal Resolution
- Excellent Low Light Sensitivity of 0.3Lux/F1.2
- Sens-up : x2 ~ x256 (0.0002Lux/F1.2)
- 12ea IR LED (Visibility Range : 5~10m)
- Day & Night
- IR Smart
- Digital WDR : Digital Wide Dynamic Range
- 2D+3D DNR : 2D+3D Digital Noise Reduction
- HSBLC : High-light Suppress BLC
- Blemish Compensation
- Board Lens f=2.9mm

Option : I-Type

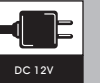
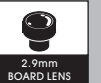

- DIMENSION -

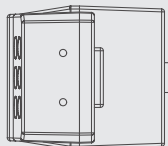
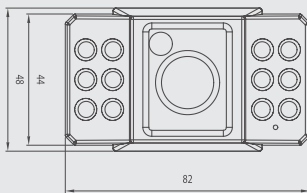
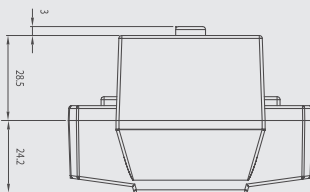

- SPECIFICATIONS -

TEC-C212QLS		
Signal Format	NTSC	PAL
Horizontal Resolution	580TV Lines	
Image Sensor	1/3" SONY High-Resolution Super HAD II CCD	
Effective Pixels	768(H) x 494(V)	752(H) x 582(V)
Scanning System	2:1 Interlace	
Synchronization	Internal	
Scanning Frequency	15.734 KHz(H), 59.94 Hz(V)	15.625 KHz(H), 50.00 Hz(V)
Video Output	CVBS : 1.0Vp-p/75Ω	
Min. Illumination	0.3Lux/F1.2 (Sens-up : 0.0002Lux/F1.2)	
Electronic Shutter	1/60 ~ 1/100,000 sec	1/50 ~ 1/100,000 sec
Iris Control	MANUAL	
Signal to Noise Ratio	50dB (AGC Off, Weight On)	
Backlight Compensation	BLC / HSBLC / OFF	
White Balance	AWB / MANUAL / INDOOR / OUTDOOR / ATW (2,000°K ~ 20,000°K)	
Gain Control	LOW / MIDDLE / HIGH / OFF	
2D+3D DNR	ON / OFF	
Day & Night	AUTO / COLOR / BW / EXT	
IR Control	ON / OFF (IR Smart)	
Sens-up	AUTO / OFF (x2 ~ x256)	
Digital WDR	ON / OFF	
Digital Zoom	ON / OFF (x256)	
Gamma	Adjustable (0.05 ~ 1.00)	
Motion Detection	ON / OFF (4 Zone)	
Privacy	ON / OFF (8 Zone)	
Mirror	MIRROR / V-FLIP / ROTATE / OFF	
Freeze	ON / OFF	
Sharpness	ON / OFF (Level Adjustable)	
Blemish Compensation	128 Points (Auto) / 4 Points (Manual)	
OSD	Built-in (English, Korean, Japanese, Chinese)	
Lens	Board Lens f=2.9mm	
LED Quantity	12 EA	
Input Voltage	DC 12V (±10%)	
Power Consumption	LED Off : Max. 2.0W / LED On : Max. 3.6W	
Operating Temp/Hum	Temperature : -10°C ~ +50°C / Humidity : 30% ~ 80% RH	
Dimension	82.0(W) x 48.0(H) x 55.7(D)mm	
Weight	Approx. 170g	

In accordance with customers' request and OSD controller's option, the specifications can be fixed or changed without notice.

- I-TYPE -



TEC-C212QLSI